

SOLLEVAMENTO LIFTING
 ATTENZIONE: UTILIZZARE N°4 FUNI DI SOLLEVAMENTO DI PARI LUNGHEZZA
 ATTENTION: USE N°4 LIFTING ROPES WITH EQUAL LENGTH ONLY

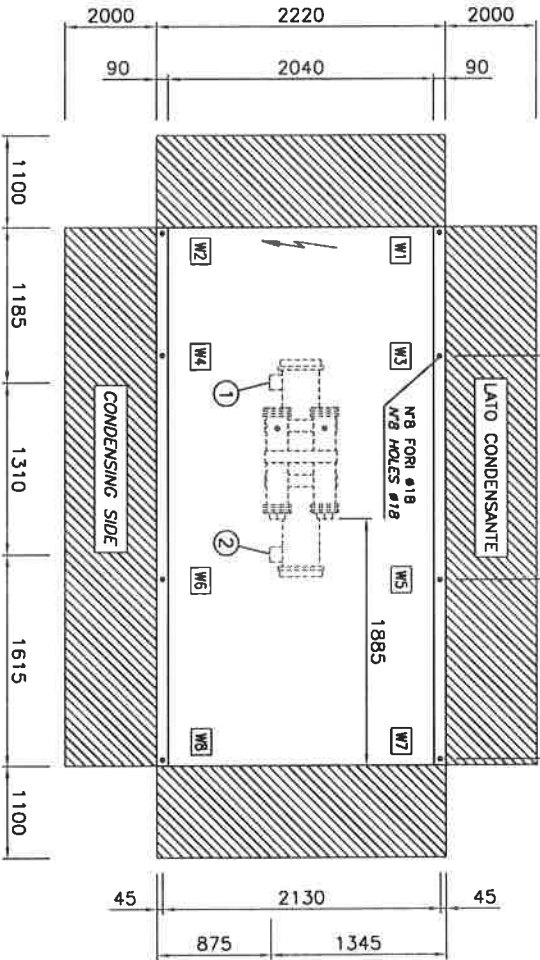
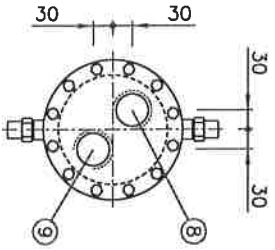

- ① ENTRATA ACQUA EVAPORATORE
EVAPORATOR WATER INLET (*)
- ② USCITA ACQUA EVAPORATORE
EVAPORATOR WATER OUTLET (*)
- ③ CONNESSIONI FLANGIATE OPZIONALI
OPTIONAL FLANGED CONNECTIONS
- ④ ENTRATA ACQUA EVAPORATORE OPZIONALE
OPTIONAL EVAPORATOR WATER INLET
- ⑤ USCITA ACQUA EVAPORATORE OPZIONALE
OPTIONAL EVAPORATOR WATER OUTLET
- ⑥ CONNESSIONI FLANGIATE ESTERNE OPZIONALI
OPTIONAL FLANGED EXTERNAL CONNECTIONS
- ⑦ CONNESSIONI GROOVELock ESTERNE OPZIONALI
OPTIONAL GROOVELock EXTERNAL CONNECTIONS
- ⑧ INGRESSO LINEA ELETTRICA (FORO PRETRANCIAITO)
POWER INLET (HOLE PRE-CUT)

TIPO-TYPE	①	②	③	④	⑤	⑥	⑧	⑨	W1	W2	W3	W4	W5	W6	W7	W8	TOTAL	TOTAL*	
WRAT	①	②	③	④	⑤	⑥	⑧	⑨	311	311	311	311	311	311	161	161	2190	2470	
WRAD									326	326	326	326	326	325	325	168	168	2290	2570

* PESO PER UNITA' CON BATTERIE ALTELTATE RAME/RAME
 WEIGHT FOR UNIT WITH COPPER/COPPER FINNED COILS

REV. N°	3	DESCRIPTION	14/01/03 MODIFIED DESUPERHEATERS CONNECTIONS
DESCRIPTION:	WATER OUTLET		
DRAWN	DATE 09/02/2001	SUBSTITUTES N°	D0329512-2
AUDITEN	DATE 14/01/2003	SUBSTITUTES BY N°	
DRAWING N°		REV. N°	
SCALE		1:40	
SHEET		1 OF 1	



BY TERM OF LAW THIS DRAWING CANNOT BE
 REPRODUCED WITHOUT OUR WRITTEN AUTHORIZATION

